



BOUNDARY ROAD, WALTHAMSTOW, E17

£1,650 OFFERS IN EXCESS

- Open-Plan Living
- Available middle February
- Ground Floor Flat
- Close to Walthamstow & Leyton
- Close to Local Amenities
- Offers over £1650pcm

wj meade
Estate Agents, Property Management & Lettings

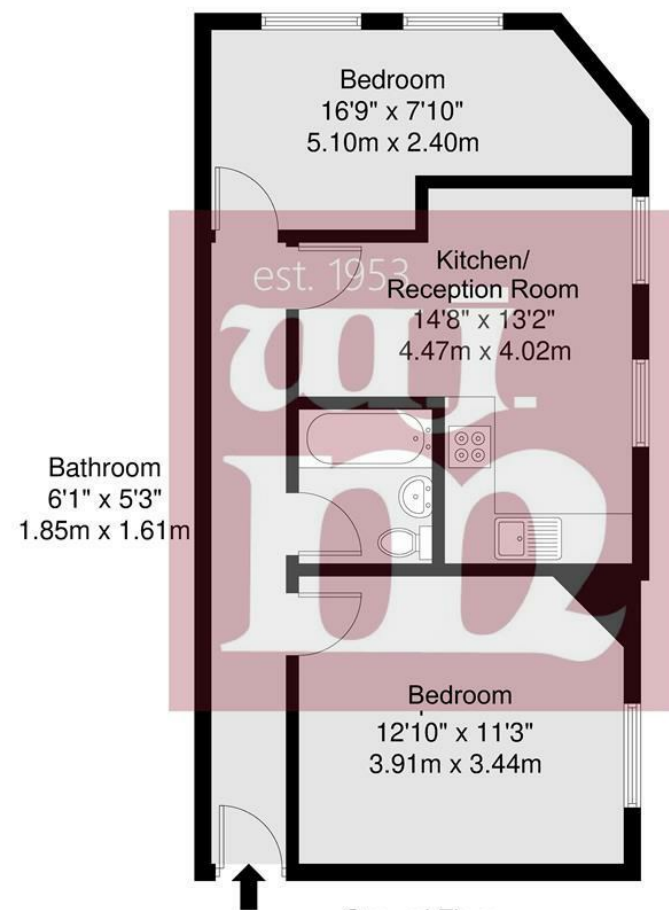

Boundary Road, E17

GROSS INTERNAL AREA
49.6 sq m / 533 sq ft

Ground Floor

GROSS INTERNAL AREA (GIA)
The footprint of the property
49.6 sq m / 533 sq ftTOTAL STORAGE SPACE
Storage and wardrobe total area
0.0 sq m / 0.0 sq ftEXTERNAL FEATURES
Garden, Balcony, Terrace, Verandah etc.
0.0 sq m / 0.0 sq ftRESTRICTED HEAD HEIGHT
Limited use areas under 1.5m
0.0 sq m / 0.0 sq ft

Disclaimer: Floorplan measurements are approximate and are for illustrative purposes only. While we do not doubt the floorplan accuracy and completeness, you or your advisors should conduct a careful, independent investigation of the property in respect of monetary valuation.

Maison
VUE

W J Meade are pleased to present this recently decorated two bedroom flat to rent in Boundary Road, E16. Situated in between Leyton & Walthamstow, the property has an abundance of local amenities and public transport nearby. Comprising two double bedrooms, family bathroom and open-plan kitchen/ reception room. Deposit is 5 week's rent

Service charge £n/a
Ground rent £n/a
Reserve fund £n/a
n/a years lease
Council tax band B
Current EPC Rating 66
Tenure:



All sizes are approximate. The Agent has not tested any apparatus, equipment, fixtures and fittings, or services and so cannot verify that they are in working order or fit for the purpose. A buyer is advised to obtain verification from their Solicitors or Surveyor. Photographs are for illustration purposes only and may depict items, which are not for sale or included in the sale price. References to tenure of a property are based upon information supplied by the vendor. The agent has not had sight of the title documents, a buyer is advised to obtain verification from their solicitor. Money Laundering Regulations 2003: Intending purchasers will be asked to produce identification, documentation at a later stage and we would ask for your co-operation in order that there will be no delay in agreeing the sale.

These particulars are intended to give a fair description of the property only and are in no way guaranteed, nor do of any contract. They are issued on the express condition that all negotiations are conducted through W.J. Meade Estate Agents. All subject to contract and to being unsold.